

ASSEMBLY INSTRUCTIONS

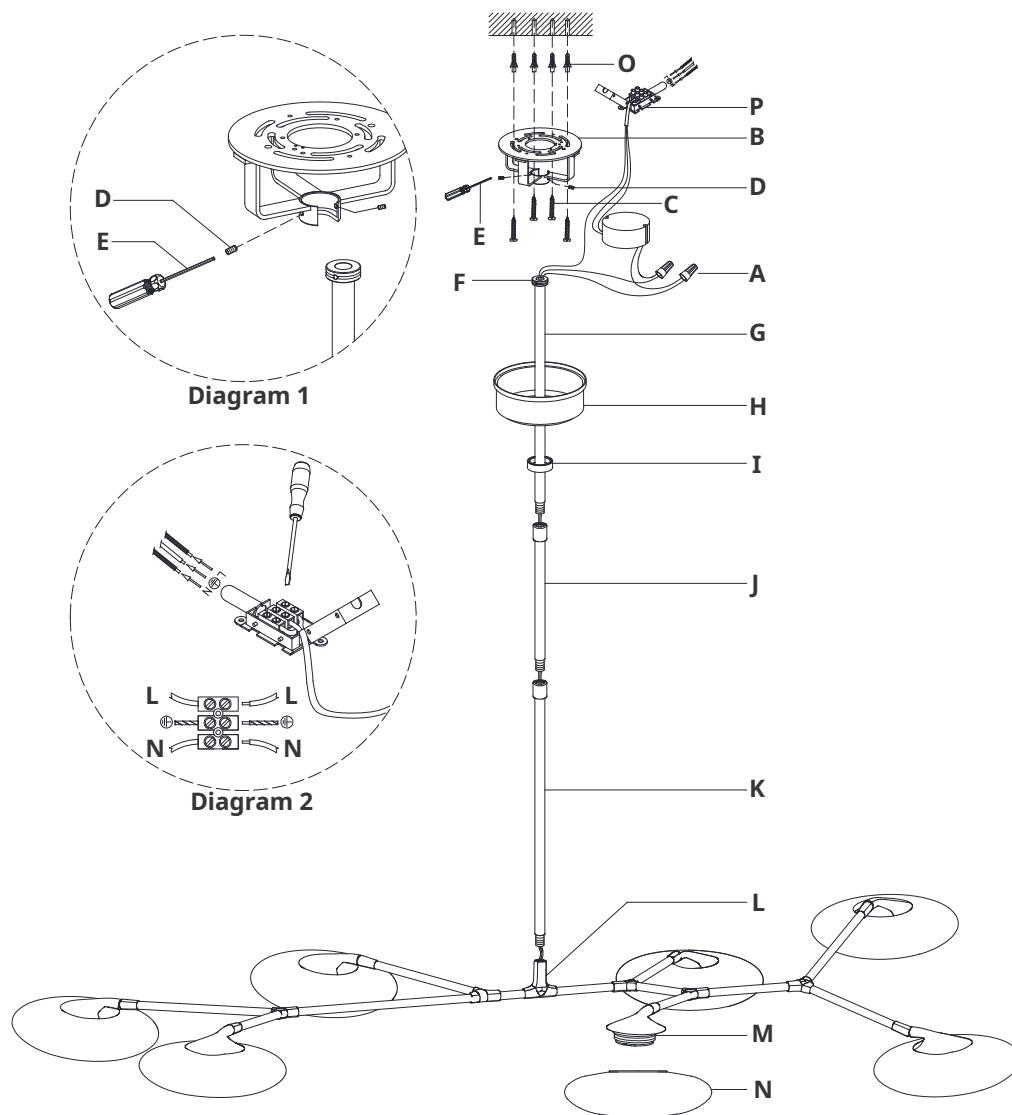

Diagram 1

Diagram 2

Brindille XL Articulating Linear Chandelier

Item # CD 5015-EU

NOTICE:

This light fixture should be installed in accordance with all applicable, local installation codes, and by a person familiar with the construction and operation of it, as well as the hazards involved. Inspect item and contents carefully. If any damage or defect is found, do not install. Retain all packaging material until installation is complete and approved.

TOOLS REQUIRED (NOT INCLUDED):

Phillips Screwdriver	Slotted Screwdriver	Wire Strippers
Wire Cutters	Pencil	Hammer
Drill		

1. Carefully remove all parts from the box. Place on a clean, soft surface.
2. Remove canopy (**H**) from mounting plate (**B**) by removing collar ring (**I**).
3. Using mounting plate (**B**) as a guide, line up with the ceiling and mark anchor positions.
4. Using a drill bit slightly smaller than the anchor, drill holes in the marked positions. Install anchors (**O**) into the holes using hammer.
5. Install mounting plate (**B**) to ceiling and secure with wood screws (**C**) to anchors (**O**).
6. Feed electrical wire through bottom rod (**K**) and connect to fixture (**L**). Repeat for middle rod (**J**), connecting to bottom rod (**K**).
7. Continue feeding wire through collar ring (**I**), canopy (**H**) and top rod (**G**).
8. Holding fixture upright, slide collar ring (**I**) and canopy (**H**) down and rest on fixture (**L**). Then connect top rod (**G**) to middle rod (**J**).
NOTE: Slide components down slowly to avoid damages.
9. Hang fixture swivel ball (**F**) to center of mounting plate (**B**) and secure with set screw (**D**) using provided wrench (**E**). See diagram 1.
10. Cut excess wires, being sure to leave enough to connect terminal block (**P**).

ASSEMBLY INSTRUCTIONS

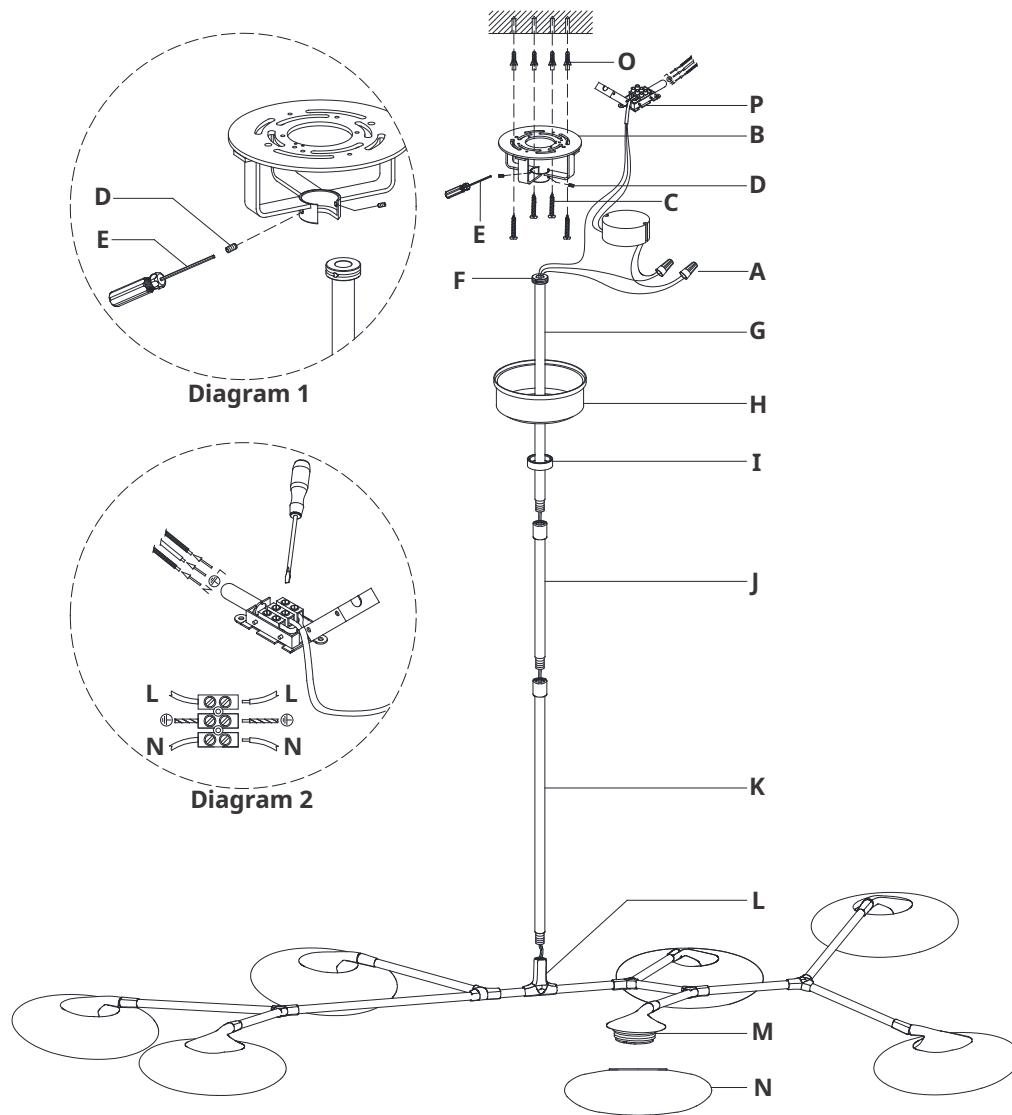

Brindille XL Articulating Linear Chandelier

Item # CD 5015-EU

NOTICE:

This light fixture should be installed in accordance with all applicable, local installation codes, and by a person familiar with the construction and operation of it, as well as the hazards involved. Inspect item and contents carefully. If any damage or defect is found, do not install. Retain all packaging material until installation is complete and approved.

11. Remove outer housing of wire by making a neat cut all the way around, about 2.5 cm from the end. Once cut is made, remove and discard the piece of housing, exposing the electrical wires.

NOTE: Make sure not to cut too deep into housing or electrical wires could become damaged.

12. Separate wires, and strip insulation on each 6 mm.
13. Connect fixture neutral wire (black) to the driver output wire (black) using wire nut (A).

14. Connect fixture hot wire (red) to the driver output wire (red) using wire nut (A).

CAUTION: Do not reverse the hot and neutral connections.

15. Open terminal block (P) to prepare for installation of electrical wires. Use diagram 2 to reference electrical installation steps below.

16. Connect fixture ground (green) and supply ground (usually green or yellow) to terminal block (P) and secure with screws.

NOTE: It is imperative that the fixture is grounded.

17. Connect neutral wires (blue) to terminal block (P) and secure with screws.

18. Connect hot wires (brown) to terminal block (P) and secure with screws. Close terminal block (P).

CAUTION: Do not reverse the hot and neutral connections.

19. Insert driver into mounting plate (B) bracket.

20. Install canopy (H) to mounting plate (B) and secure with collar ring (I).

21. Thread glass shades (N) to metal caps (M).

NOTE: Do not over-tighten otherwise shade could become damaged.

Care Instructions: Clean only with a soft dry cloth or feather duster. Do not use abrasive or chemical agents.