

ASSEMBLY INSTRUCTIONS

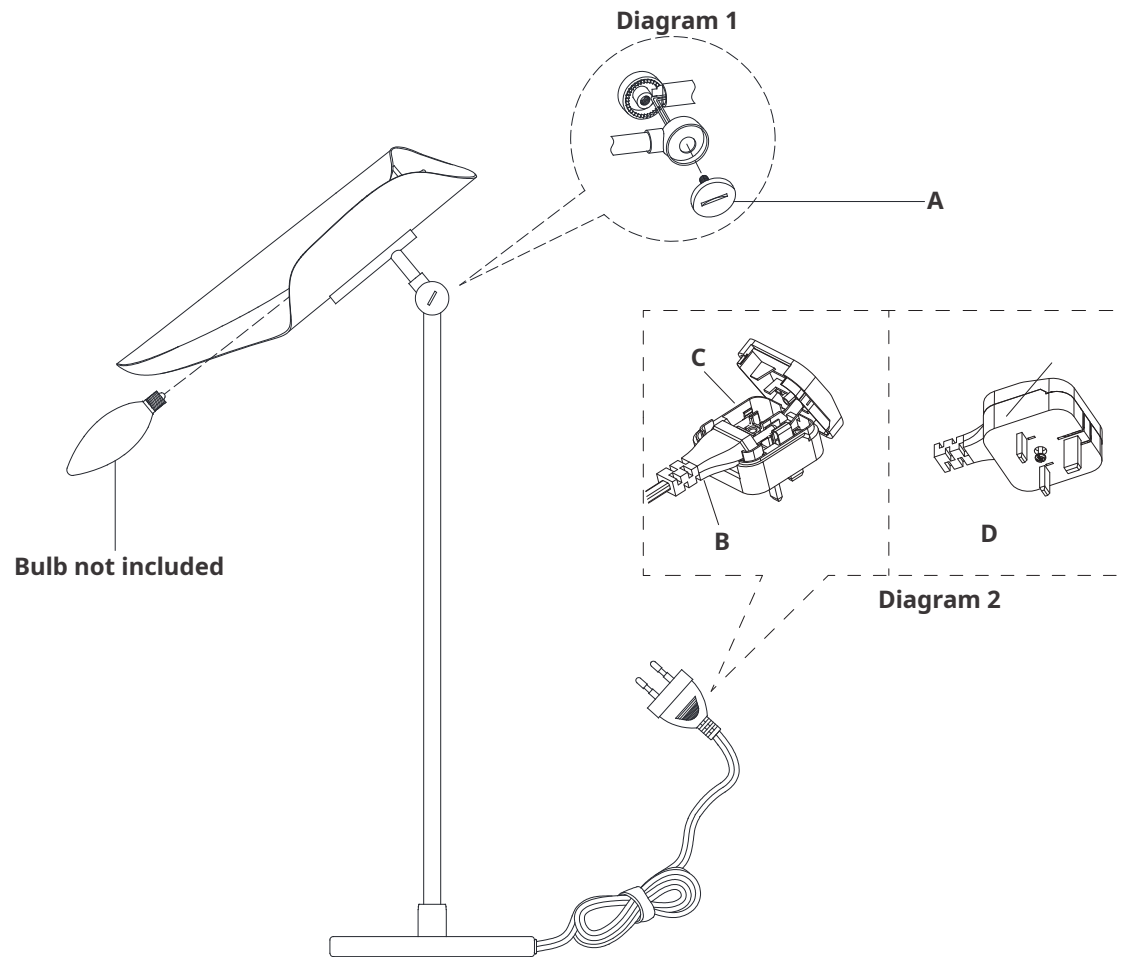

Flore Desk Lamp

Item # CD 3020-EU

NOTICE:

This light fixture should be installed in accordance with all applicable, local installation codes, and by a person familiar with the construction and operation of it, as well as the hazards involved. Inspect item and contents carefully. If any damage or defect is found, do not install. Retain all packaging material until installation is complete and approved.

TOOLS REQUIRED (NOT INCLUDED):

Phillips Screwdriver

1. Carefully remove all parts from the box. Place on a clean, soft surface.
2. Install light bulb into the socket.
3. To adjust shade angle, loosen knob **(A)** and adjust to desired angle, then tighten knob **(A)**. See diagram 1.
4. Plug into electrical outlet and test fixture.

UK PLUG ADAPTER INSTRUCTIONS

- a. Open adapter cover by loosening screw **(D)**.
- b. Insert plug **(B)** into adapter **(C)** as shown in diagram 2.
- c. Close adapter cover and secure with screw **(D)**.

Care Instructions: Clean only with a soft dry cloth or feather duster. Do not use abrasive or chemical agents.