

ASSEMBLY INSTRUCTIONS

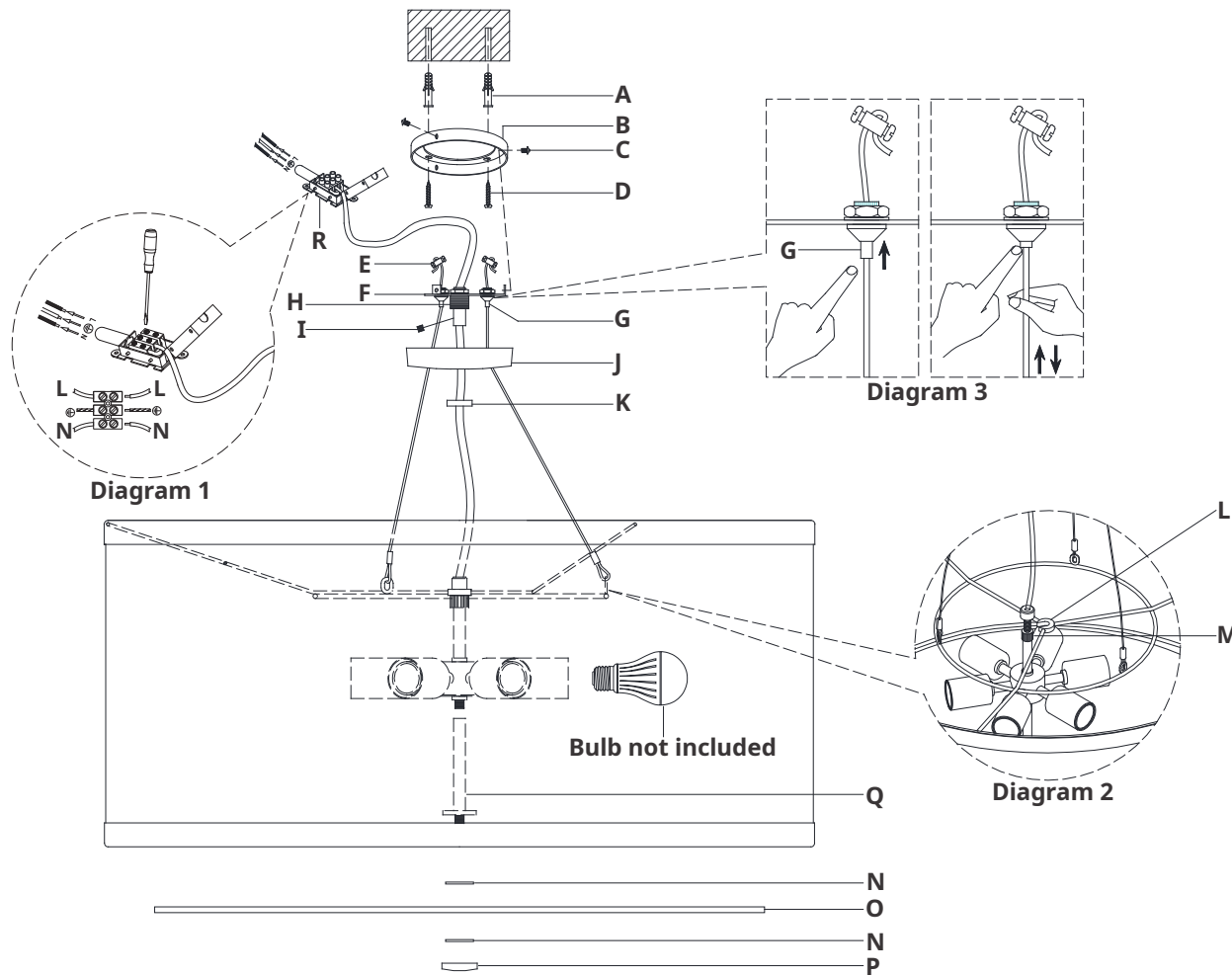

Walker Large Hanging Shade

Item # KS 5079EU

NOTICE:

This light fixture should be installed in accordance with all applicable, local installation codes, and by a person familiar with the construction and operation of it, as well as the hazards involved. Inspect item and contents carefully. If any damage or defect is found, do not install. Retain all packaging material until installation is complete and approved.

TOOLS REQUIRED (NOT INCLUDED):

Phillips Screwdriver	Slotted Screwdriver	Measuring Tape
Wire Cutters	Wire Strippers	Pencil
Drill	Hammer	

PERSONS REQUIRED: Two

1. Carefully remove all parts from the box. Place on a clean, soft surface.
2. Remove canopy (J) from bracket (F) by removing collar ring (K).
3. Remove mounting plate (B) from bracket (F) by removing screws (C).
4. Using the mounting plate (B) as a guide, line up with the ceiling and mark anchor positions.
5. Using a drill bit slightly smaller than the anchor, drill holes in the marked positions. Install anchors (A) into the holes using hammer.
6. Line up mounting plate (B) to anchors and secure with screws (D).
7. Install shade split washer (L) above knurled ring (M) and secure by screwing tight as shown in diagram 2.
8. Locate the three steel hanging cables on top of shade. Run cable through canopy (J), then insert through cable stopper (G) by pushing up as shown on diagram 3. Adjust to desired height then repeat steps with remaining cables.
9. Loosen set screw and feed fixture electrical wire through the collar ring (K), canopy (J), collar loop (H) and bracket (F). Adjust wire to desired length then tighten set screw.

NOTE: Make sure there is no tension on the electrical wire when fixture is fully extended.

ASSEMBLY INSTRUCTIONS

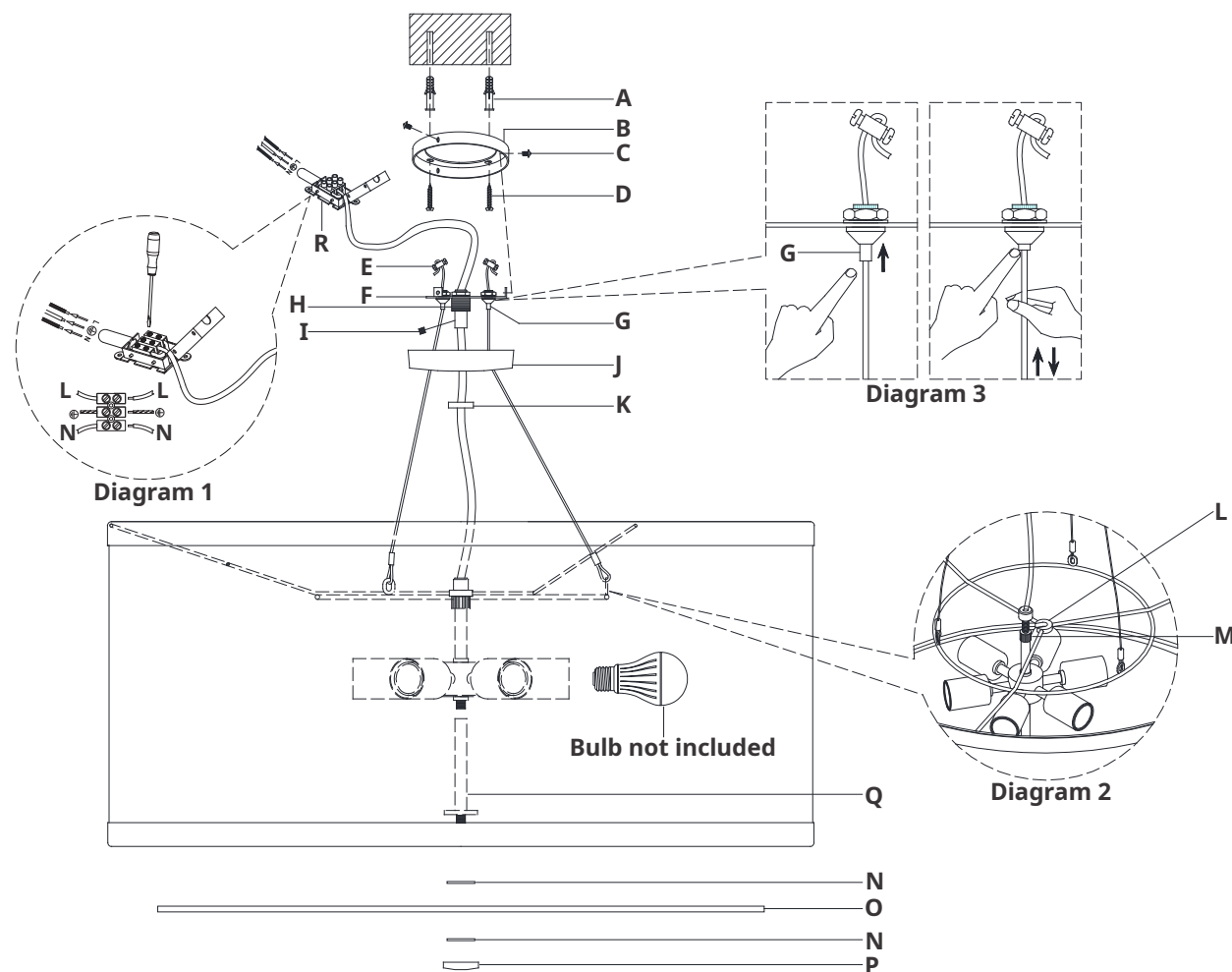

Walker Large Hanging Shade

Item # KS 5079EU

NOTICE:

This light fixture should be installed in accordance with all applicable, local installation codes, and by a person familiar with the construction and operation of it, as well as the hazards involved. Inspect item and contents carefully. If any damage or defect is found, do not install. Retain all packaging material until installation is complete and approved.

10. Cut excess wires, being sure to leave enough to connect the terminal block (R).
11. Remove outer housing of wire by making a neat cut all the way around, about 2.5 cm from the end. Once cut is made, remove and discard the piece of housing, exposing the electrical wires.
NOTE: Make sure not to cut too deep into housing or electrical wires could become damaged.
12. Separate wires, and strip insulation on each 6 mm.
NOTE: It is recommended to have a helper assist in supporting the fixture in steps 13-17.
13. Open terminal block (R) to prepare for installation of electrical wires. Use diagram 1 to reference electrical installation steps below.
14. Connect fixture ground (green) and supply ground (usually green or yellow) to terminal block (R) and secure with the screws.
NOTE: It is imperative that the fixture is grounded.
15. Connect neutral wires (blue) to terminal block (R) and secure with screws.
16. Connect hot wires (brown) to terminal block (R) and secure with screws. Close terminal block (R).
CAUTION: Do not reverse the hot and neutral connections.
17. Install fixture by securing bracket (F) to mounting plate (B) using screws (C).
18. Install canopy (J) to collar loop (H) and secure with collar ring (K).
19. Install light bulbs (not included) into the sockets.

ASSEMBLY INSTRUCTIONS

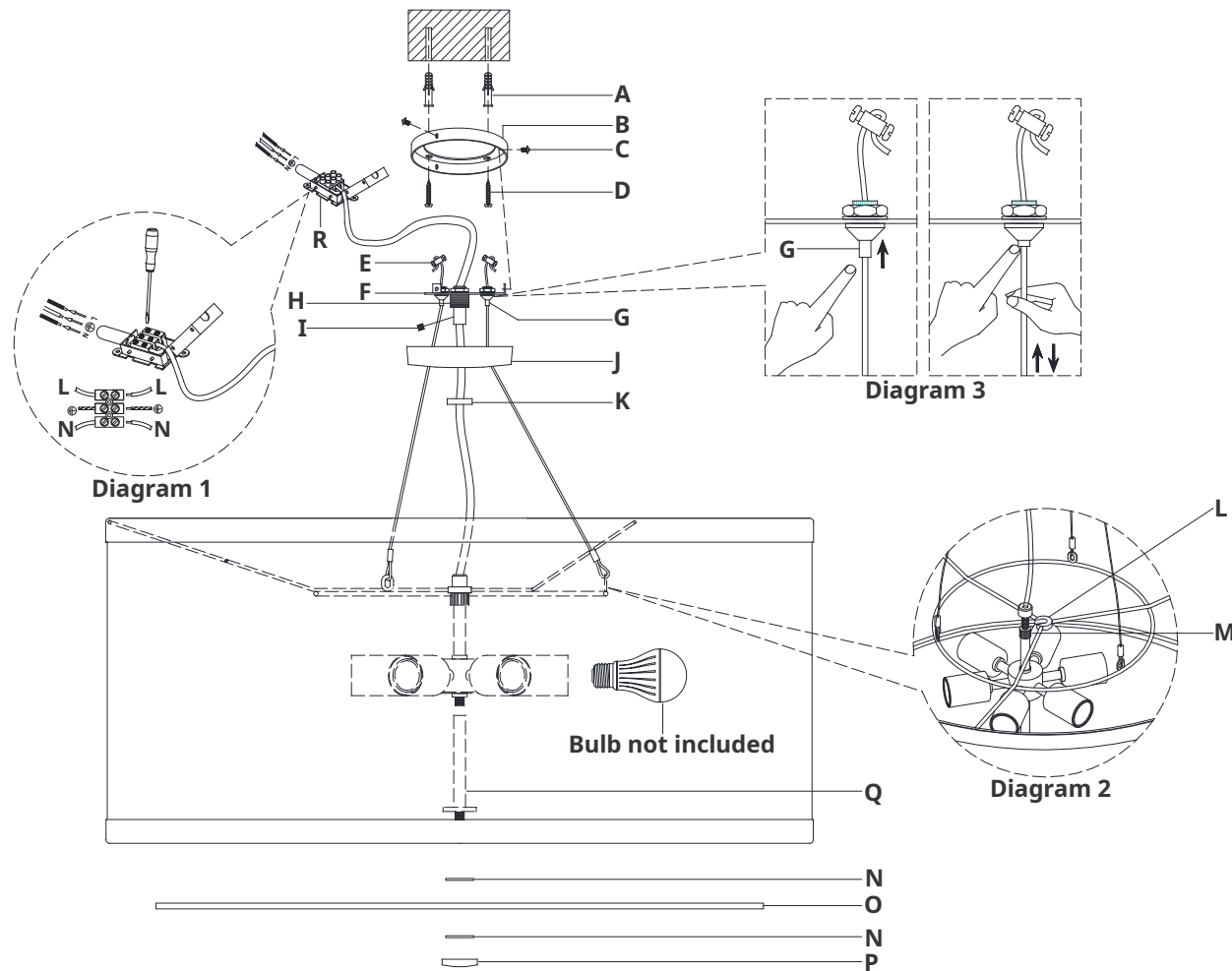

Walker Large Hanging Shade

Item # KS 5079EU

NOTICE:

This light fixture should be installed in accordance with all applicable, local installation codes, and by a person familiar with the construction and operation of it, as well as the hazards involved. Inspect item and contents carefully. If any damage or defect is found, do not install. Retain all packaging material until installation is complete and approved.

20. Thread rod (**Q**) to the bottom of fixture body.

21. Attach rubber washers (**N**) to either side of the diffuser (**O**) and secure to rod (**Q**) with finial (**P**).

Care Instructions: Clean only with a soft dry cloth or feather duster. Do not use abrasive or chemical agents.